

# Flex Building for Lease

1830 SUPERIOR AVENUE, CLEVELAND, OH 44114



## Overview

Location X 3. The Superior Arts/Campus District is transforming into the hottest neighborhood in downtown with the new Cross Country Mortgage HQ, Board of Elections and Cleveland Police HQ.

Rare 10,000 SF flex building, including 6,200 SF warehouse with 2 overhead doors and a contiguous front retail space at 4,300 SF.

Close to CBD, Campus District, AsiaTown and all major highways.

## Highlights

- Across From the New Board of Elections
- Private Parking: 10 Spaces
- 18' Clear Height
- Warm Dark Shell Condition

## Property Details



**Lease Rate**  
\$9.75 SF/YR  
(NNN)



**Building Size**  
10,547 SF



**Lot Size**  
0.34 Acres

Rev: April 15, 2024



# Flex Building for Lease

1830 SUPERIOR AVENUE, CLEVELAND, OH 44114



Rev: April 15, 2024



## Our Network Is Your Edge

All information is from sources deemed reliable and is subject to errors, omissions, change of price, rental, prior sale, and withdrawal without notice. Prospect should carefully verify each item of information contained herein.

**Joe Zumpano**

C: 330.990.0847

O: 330.940.9360

JZumpano@HoffLeigh.com



# Flex Building for Lease

1830 SUPERIOR AVENUE, CLEVELAND, OH 44114

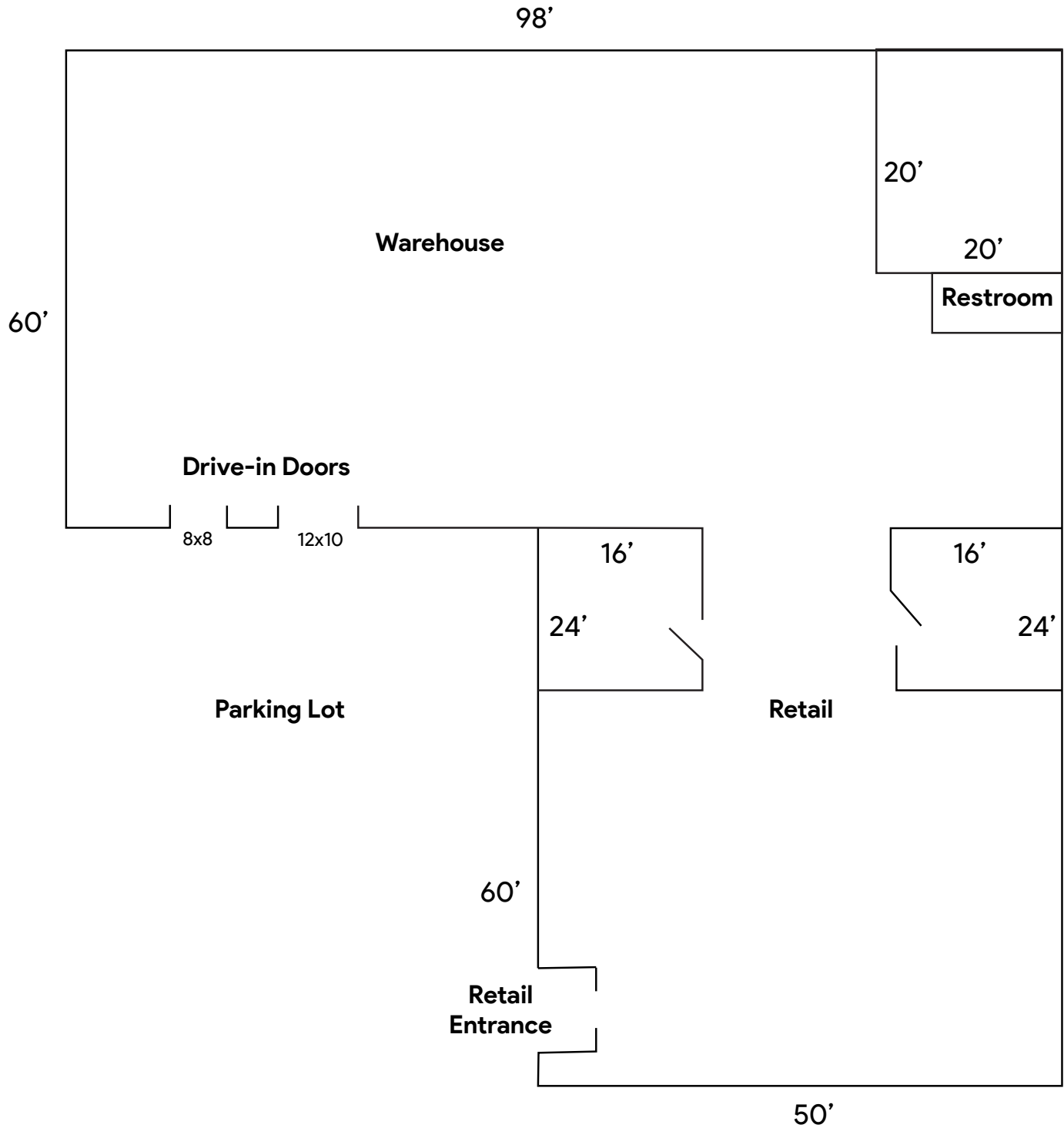

Rev: April 15, 2024

## Our Network Is Your Edge



All information is from sources deemed reliable and is subject to errors, omissions, change of price, rental, prior sale, and withdrawal without notice. Prospect should carefully verify each item of information contained herein.

**Joe Zumpano**

C: 330.990.0847

O: 330.940.9360

JZumpano@HoffLeigh.com

# Flex Building for Lease

1830 SUPERIOR AVENUE, CLEVELAND, OH 44114

1830 Superior Ave E, Cleveland, Ohio, 44114

## DEMOGRAPHICS



73,843  
Population



33.8  
Median Age



1.9  
Average  
Household Size



\$38,346  
Median Household  
Income

## TRAFFIC COUNT

Cross street	VPD	Distance
E Superior Ave	5,850	0.0
E Superior Ave	5,150	0.1
E 21st St	5,665	0.1
E Superior Ave	658	0.1
E Superior Ave	3,250	0.1

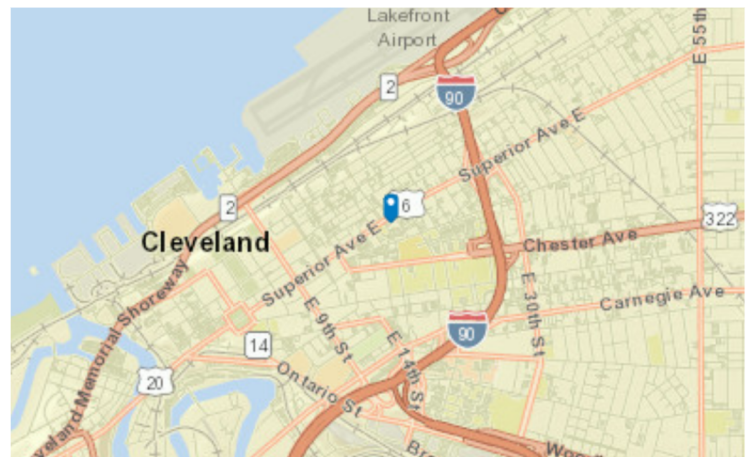

Rev: April 15, 2024



# Flex Building for Lease

1830 SUPERIOR AVENUE, CLEVELAND, OH 44114



Rev: April 15, 2024



## Our Network Is Your Edge

All information is from sources deemed reliable and is subject to errors, omissions, change of price, rental, prior sale, and withdrawal without notice. Prospect should carefully verify each item of information contained herein.

**Joe Zumpano**

C: 330.990.0847

O: 330.940.9360

JZumpano@HoffLeigh.com