

Affordable Office Space in 80906

1235 - 1255 LAKE PLAZA DRIVE, COLORADO SPRINGS, CO 80906



Overview

1235-1255 Lake Plaza are professional office buildings located in Southwest Colorado Springs. The new owners are in the process of renovating the exterior and interior. Enjoy quick I-25 access, ample parking, walking distance restaurants and extraordinary drive-by visibility; just minutes from the Broadmoor Hotel!

Unit:	Size:	Price:
1235 Lake - Suite 125	831 SF	\$1,250 / Month (Gross)
1235 Lake - Suite 127	677 SF	\$1,000 / Month (Gross)
1235 Lake - Suite 125 - 127	1,508 SF	\$2,250 / Month (Gross)
1255 Lake - Suite 268	1,252 SF	\$1,950 / Month (Gross)

Highlights

- Ample Parking
- Elevator Access
- Quick I-25 Access
- Flexible Floor Plans
- New Landscaping
- Gross Lease Terms

Property Details



Lease Rate

\$17.73 - \$18.69 SF/YR (Gross)



Space Available

677 - 1,508 RSF



Zoning

PBC

Rev: July 18, 2025

Our Network Is Your Edge

All information is from sources deemed reliable and is subject to errors, omissions, change of price, rental, prior sale, and withdrawal without notice. Prospect should carefully verify each item of information contained herein.

Holly Trinidad

C: 719.337.0999

O: 719.630.2277

Holly@HoffLeigh.com

Chris Myers

C: 719.650.4627

O: 719.630.2277

CMyers@HoffLeigh.com



Affordable Office Space in 80906

1235 - 1255 LAKE PLAZA DRIVE, COLORADO SPRINGS, CO 80906



Rev: July 18, 2025



Our Network Is Your Edge

All information is from sources deemed reliable and is subject to errors, omissions, change of price, rental, prior sale, and withdrawal without notice. Prospect should carefully verify each item of information contained herein.

Holly Trinidad
C: 719.337.0999
O: 719.630.2277
Holly@HoffLeigh.com

Chris Myers
C: 719.650.4627
O: 719.630.2277
CMyers@HoffLeigh.com



Affordable Office Space in 80906

1235 - 1255 LAKE PLAZA DRIVE, COLORADO SPRINGS, CO 80906



Rev: July 18, 2025



Our Network Is Your Edge

All information is from sources deemed reliable and is subject to errors, omissions, change of price, rental, prior sale, and withdrawal without notice. Prospect should carefully verify each item of information contained herein.

Holly Trinidad

C: 719.337.0999

O: 719.630.2277

Holly@HoffLeigh.com

Chris Myers

C: 719.650.4627

O: 719.630.2277

CMyers@HoffLeigh.com

Affordable Office Space in 80906

1235 - 1255 LAKE PLAZA DRIVE, COLORADO SPRINGS, CO 80906

Suite 125 - 127

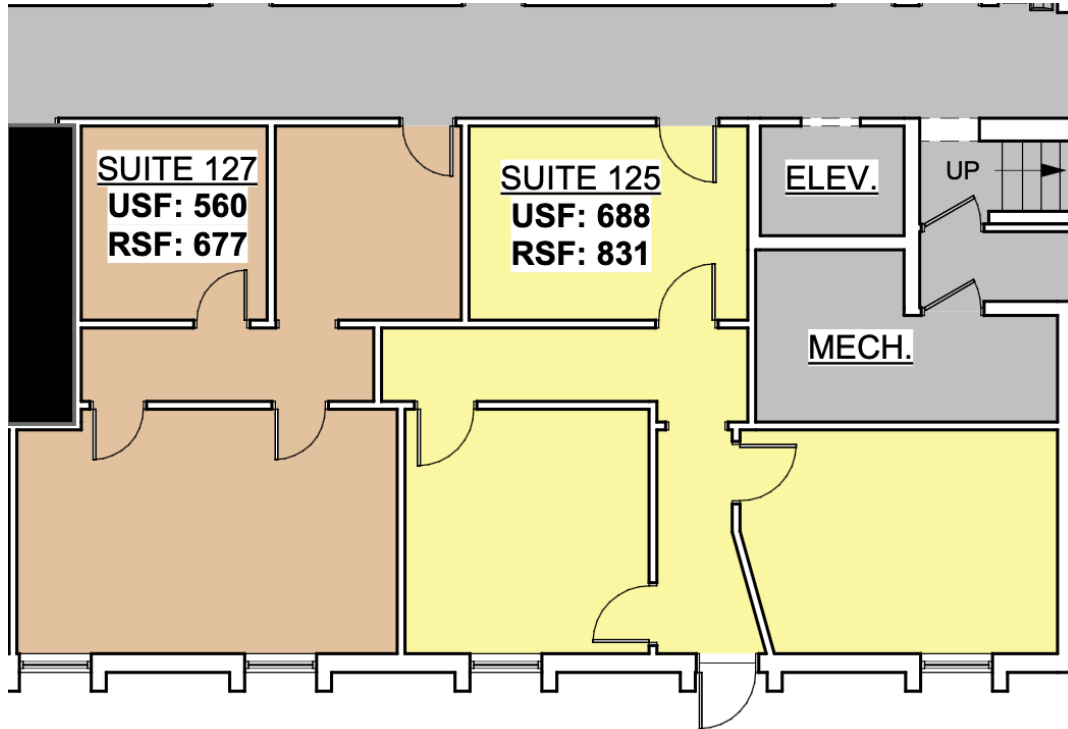

Suite 268

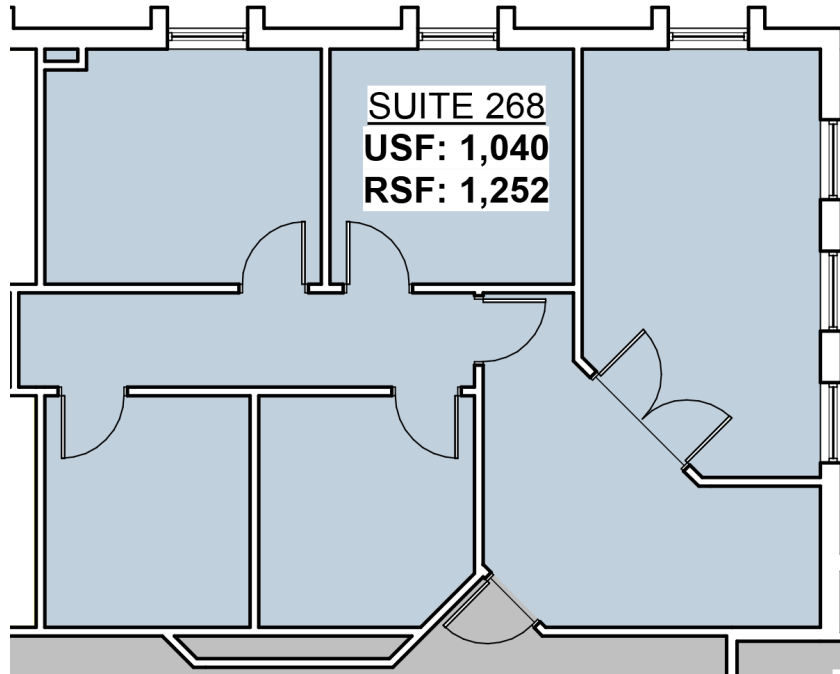

Rev: July 18, 2025

Our Network Is Your Edge

All information is from sources deemed reliable and is subject to errors, omissions, change of price, rental, prior sale, and withdrawal without notice. Prospect should carefully verify each item of information contained herein.

Holly Trinidad

C: 719.337.0999

O: 719.630.2277

Holly@HoffLeigh.com

Chris Myers

C: 719.650.4627

O: 719.630.2277

CMyers@HoffLeigh.com

Affordable Office Space in 80906

1235 - 1255 LAKE PLAZA DRIVE, COLORADO SPRINGS, CO 80906



Rev: July 18, 2025

Our Network Is Your Edge

All information is from sources deemed reliable and is subject to errors, omissions, change of price, rental, prior sale, and withdrawal without notice. Prospect should carefully verify each item of information contained herein.

Holly Trinidad

C: 719.337.0999

O: 719.630.2277

Holly@HoffLeigh.com

Chris Myers

C: 719.650.4627

O: 719.630.2277

CMyers@HoffLeigh.com