

Industrial Building for Lease or Sale

722 CLARK PLACE, COLORADO SPRINGS, CO 80915



Overview

The property has the following:

- 29,700 RSF with Roughly 1,000 RSF of Office and the Balance Warehouse
- 28' Ceilings in the Warehouse
- 2' X 18' Drive-In, Over Head Doors
- Wet Fire Suppression System Throughout the Warehouse Space
- 3 Phase, 208/120 Voltage
- Ample Outdoor Storage - 4.64 Acres
- Walking Path Directly Behind the Building!
- Zoning: PIP1

For all the confidential financial details call:

Tim Leigh: (719) 337-9551 or Holly Trinidad (719) 337-0999

Property Details



Lease Rate

\$10.50 SF/YR (NNN)



Sales Price

\$5,940,000



Zoning

PIP-1



Space Available

29,700 SF



Building Size

29,700 SF

Rev: October 20, 2023

Our Network Is Your Edge

All information is from sources deemed reliable and is subject to errors, omissions, change of price, rental, prior sale, and withdrawal without notice. Prospect should carefully verify each item of information contained herein.

Tim Leigh

C: 719.337.9551

O: 719.630.2277

Tim@HoffLeigh.com

Holly Trinidad

C: 719.337.0999

O: 719.630.2277

Holly@HoffLeigh.com

Industrial Building for Lease or Sale

722 CLARK PLACE, COLORADO SPRINGS, CO 80915

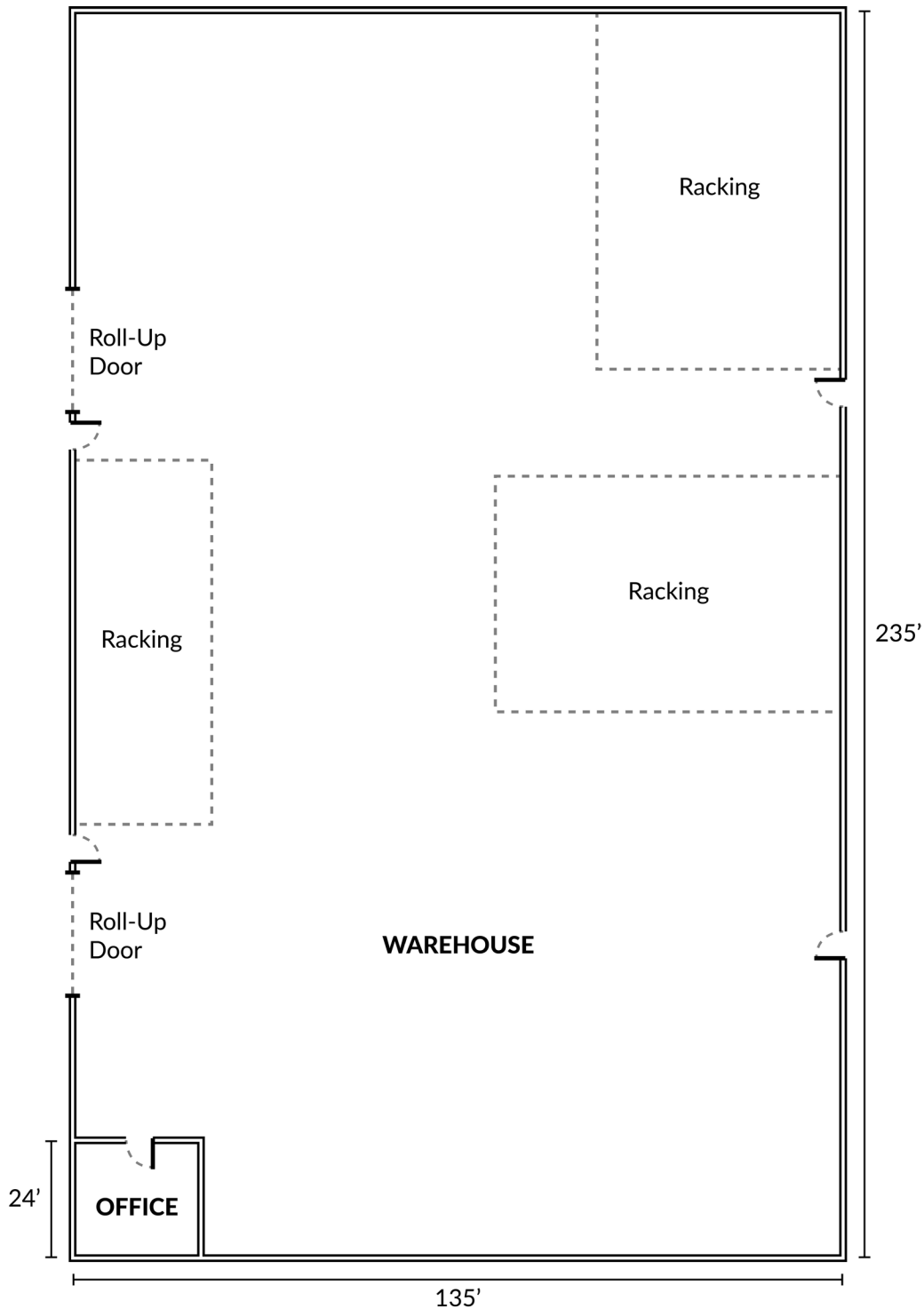

Rev: October 20, 2023

Our Network Is Your Edge

All information is from sources deemed reliable and is subject to errors, omissions, change of price, rental, prior sale, and withdrawal without notice. Prospect should carefully verify each item of information contained herein.

Tim Leigh
C: 719.337.9551
O: 719.630.2277
Tim@HoffLeigh.com

Holly Trinidad
C: 719.337.0999
O: 719.630.2277
Holly@HoffLeigh.com



Industrial Building for Lease or Sale

722 CLARK PLACE, COLORADO SPRINGS, CO 80915

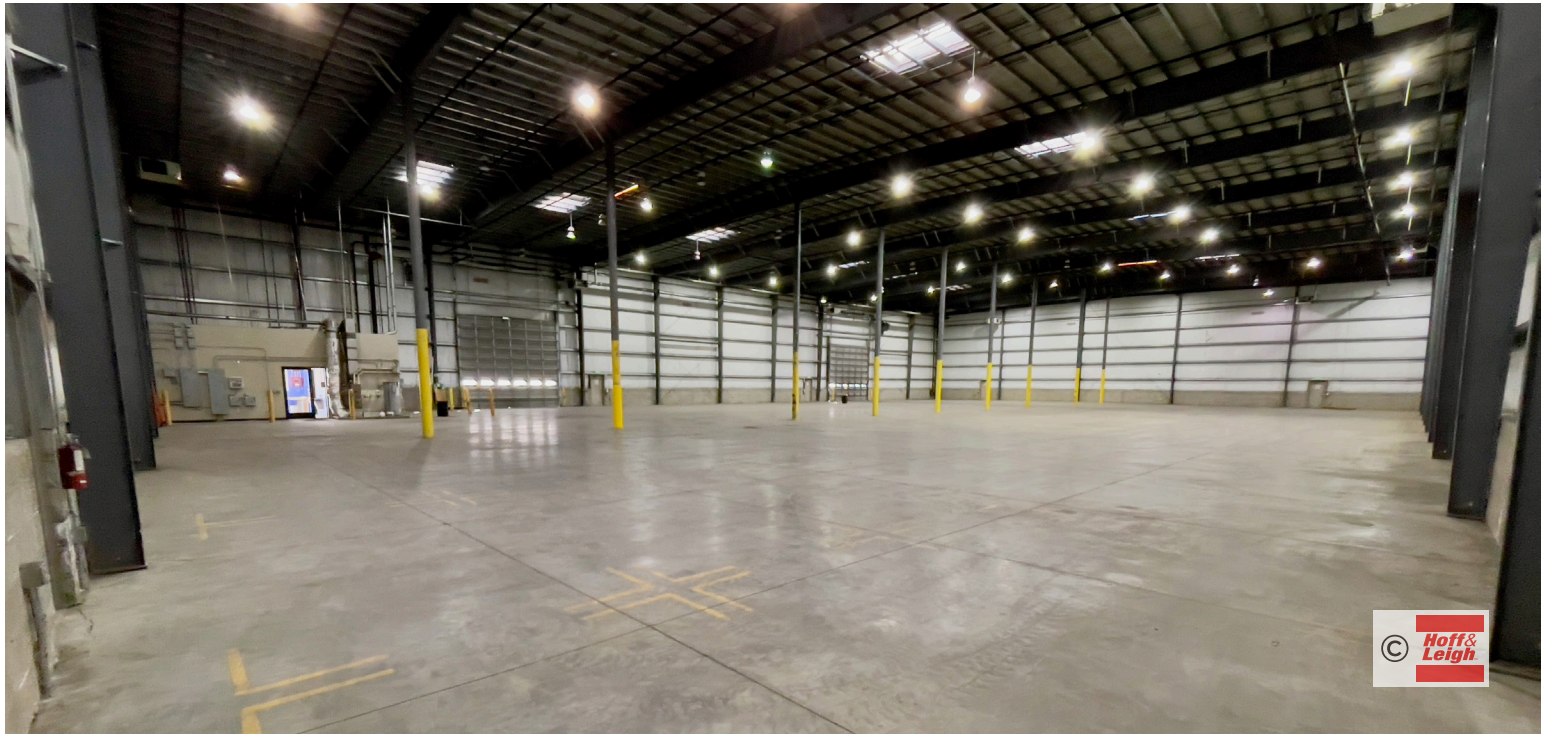

Rev: October 20, 2023



Our Network Is Your Edge

All information is from sources deemed reliable and is subject to errors, omissions, change of price, rental, prior sale, and withdrawal without notice. Prospect should carefully verify each item of information contained herein.

Tim Leigh

C: 719.337.9551

O: 719.630.2277

Tim@HoffLeigh.com

Holly Trinidad

C: 719.337.0999

O: 719.630.2277

Holly@HoffLeigh.com



Industrial Building for Lease or Sale

722 CLARK PLACE, COLORADO SPRINGS, CO 80915

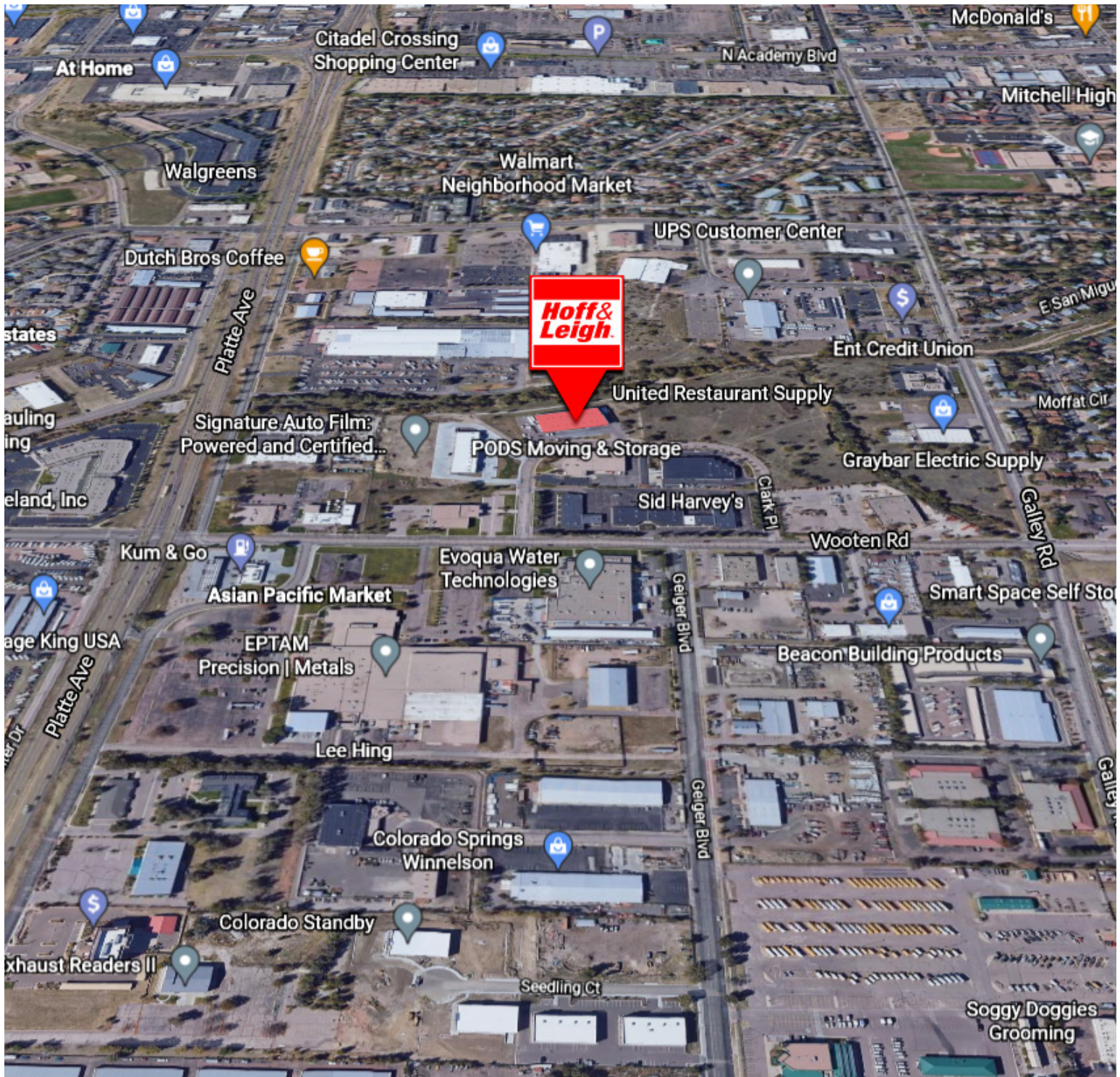

Rev: October 20, 2023



Our Network Is Your Edge

All information is from sources deemed reliable and is subject to errors, omissions, change of price, rental, prior sale, and withdrawal without notice. Prospect should carefully verify each item of information contained herein.

Tim Leigh

C: 719.337.9551

O: 719.630.2277

Tim@HoffLeigh.com

Holly Trinidad

C: 719.337.0999

O: 719.630.2277

Holly@HoffLeigh.com